

User Manual

Contents

Preface	2
Feature.....	3
Preparation	4
Battery.....	4
How to charge your hearing aid.....	5
How to deal with earhook	7
Operation.....	8
ON and OFF.....	8
Volume Control	8
Memory Switch	9
Maintenance.....	10
Q & A.....	10
Cleaning.....	11
Appendix.....	12

Preparation

Congratulations! Welcome to a New Life created by NewSound Rechargeable Behind-The-Ear hearing instrument(called BTE here). Please read this manual carefully before use.

Intended use

This Hearing instrument is an electronic device which amplifies sounds from the surrounding environment. It will help people with mild to moderate hearing loss or those who just want to enhance their ability to hear conversations in a noisy environment. This rechargeable hearing aid is intended to make daily use more convenient and the elimination of having to change the batteries every week.

Scope

This user manual only applies to rechargeable BTE hearing instrument.

Precautions

For patients with middle ear infection , hearing instrument can't be worn until cured or follow your doctor's recommendation.

Please consult your hearing healthcare professional first when you have any questions about your hearing or your hearing instrument.

THE MANUFACTURER RESERVES THE RIGHT TO MODIFY THE TECHNICAL SPECIFICATIONS OF THE PRODUCT WITHOUT ANY PRIOR NOTICE .

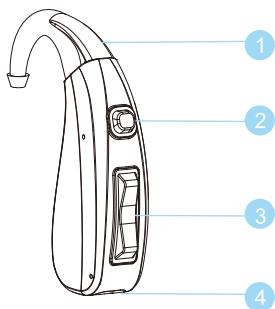

1. Ear hook
2. Memory Switch
3. Rocker Volume Control
4. Battery Door

Preparation

Battery

1. Power is supplied by a lithium polymer battery and should not be removed, except by an authorized service center.
2. A full charge takes about 2 hours, and will allow for up to 20 hours of use.
3. The recharging process will automatically shut off when the battery is fully charged. Do not use the instrument when being charged.
4. To maximize the extended life of the battery, keep the hearing aid plugged into the charger when not in use for an extended period of time.

WARNING: DO NOT ATTEMPT TO REPLACE THE BATTERY BY YOURSELF. CONTACT THE MANUFACTURER OR WHERE YOU BOUGHT THE HEARING INSTRUMENT FOR FURTHER HELP.

How to charge your hearing aids

Charging the hearing instrument is similar to charging a cellphone.

1. The USB cable supplied with the hearing aid has on one side the micro-USB connector and this will fit into the end of the hearing aid to charge it. On the other end of the cable is the full USB connector and this will plug into the supplied AC power plug connector, a computer USB port or any other standard USB power source used for charging other electronic devices.
2. We recommend that you fully charge the hearing instrument before using it for the first time.
3. When the USB cable is connected to a power source and the micro-USB connector is inserted in the hearing instrument, there will be a red LED light that will glow to indicate that the hearing instrument is being charged. When the instrument is fully charged the red LED indicator will turn green and will be ready to use. There is no harm by leaving the hearing instrument connected to the power source after it is fully charged, since the advanced circuitry regulates and monitors this condition.

Notice: If you need to use the hearing instruments before the charging cycle is complete, the operation time can be shorter than usual.

Full charging time: 2 Hours

Duration of use: Approximately 20 Hours of normal use under maximum Volume

Cycle times: No decline within 500 times

Less than 15% decline over 500 times

Less than 75% decline over 1000 times

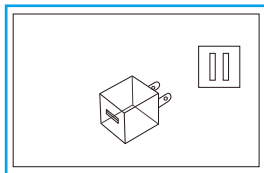
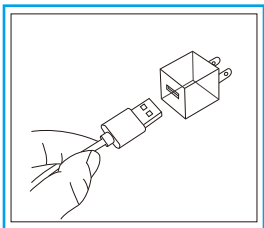
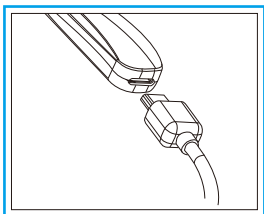

How to deal with the earhook

Attach your hearing instrument parts

1. Choose the suitable earmold (or eartip), and then connect the adaptor and sound tube.



2. Cut off the unneeded part of sound tube as shown to achieve a comfortable length. Connect the sound tube to the earhook.



Put on your hearing instrument

Step 1: Hold the earmold (or eartip) by the outer side near the tubing. Insert the canal tip of the earmold into your ear canal gently. Then softly press the earmold into place.

Step 2: Carefully place the BTE behind your ear with the ear hook and sound tube wrapped over the top.

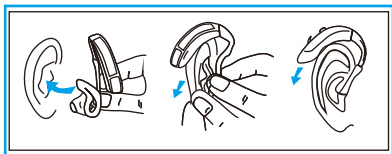

Operation

ON and OFF

TO TURN ON - Long press the memory switch for 3 seconds to turn on the instrument. When the hearing instrument is turned on at first time, it will automatically be in program I-microphone mode. After that, the instrument will revert to the previous setting of program when powered on again.

TO TURN OFF - Long press the memory switch for 3 seconds to turn off the instrument.

Volume Control

The volume control operates as described below:

For all adjustments place thumb into the helix portion of your ear. Next, take your index finger and place it on the rocker switch.

Briefly push/ release the top half of the switch to increase volume, and bottom half of switch to decrease the volume .Each short press changes the volume slightly.

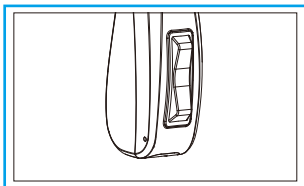

Memory Switch

Your hearing instrument can be programmed 2 different listening programs.

The additional settings which are pre-programmed for your specific needs are accessed by the memory switch. Each time you press the memory switch, the hearing instrument will move to the next program. The sequence is 1, 2, 1...

Your hearing instrument will alert to help you identify which program you are using. When you select program 1 you will hear one beep, program 2 will emit two beeps.

Please note that the programs are preset by your hearing healthcare professional or manufacturer.

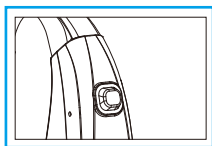

Q & A

1. How to charge the device?

Connect the device with Micro-USB cable, connect to the AC adapter and plug into 120/220V outlet or plug into computer's USB port.

2. How long does it takes for the device to be fully charged?

It takes 1.5-2 hours to fully charge this device.

3. How long is the working time of the device after fully charged?

The device can work for about 20 hours after fully charged under quiet environments. In loud surroundings, it takes more power for the hearing instrument to filter out sounds and thus may have a shorter usage time, but it will not diminish drastically.

4. Why the device is not working during the charging phase?

The device will be turned off automatically to make for a faster charging time. It is recommended that you turn off the hearing instrument when it is not in use to prevent the battery from discharging totally and to prevent any feedback noise.

5. How to know when the hearing device is fully charged?

When the device starts to charge, the LED indicator light will glow with red light and when the device is fully charged, the light will turn green.

6. How to maintain the hearing instrument charging system?

To get the maximum use from the internal battery, it is recommended that the hearing instrument is charged on a daily basis which is typically overnight. It is also recommended that if the hearing instrument is not used for an extended period of time during the day, that the hearing instrument is turned off by long press the memory switch.

or plug the hearing instrument into the USB cable and power source.

7. Can the user replace the battery?

The user cannot replace the battery since it is sealed inside the case, If the hearing instrument needs service, please contact where you bought the hearing instrument from and they will be able to assist with further information.

Cleaning

Cerumen will accumulate on it while using your hearing instrument during use. It will damage the instrument if the cerumen enters it.

Cleaning is easier when accumulated cerumen is dry; e.g., in the morning, before you insert the instrument into your ear.

Cleaning the instrument

Clean your instrument with a soft, dry cloth and the small brush. Do the cleaning on the soft table to avoid damage or scratch if the instrument falls.



Do not use water or other fluids.

Appendix

Working Condition

Temperature should not exceed limits of $-20^{\circ}/60^{\circ}$ Celsius at a relative air humidity of 85% for extended periods during transportation and storage. Air pressure between 500 and 1100 hPa is not detrimental to the instrument.

Data Standard

Maximum Output (2cc-coupler / IEC-118-7/2005)



European Representative

Wellkang Ltd t/a Wellkang Tech Consulting
Suite B, 29 Harley Street
LONDON W1G 9QR
England, United Kingdom



FDA information

Following the medical evaluation, the physician will give you a written statement that states that your hearing loss has been medically evaluated and that you may be considered a candidate for a hearing aid. The physician will refer you to an audiologist or hearing aid dispenser, as appropriate, for a hearing aid evaluation.

The audiologist or hearing aid dispenser will conduct a hearing aid evaluation to assess your ability to hear with and without a hearing aid. The hearing aid evaluation will enable the audiologist or dispenser to select and fit a hearing aid to your individual needs.

If you have reservations about your ability to adapt to amplification, you should inquire about the availability of a trial rental or purchase-option program. Many hearing aid dispensers now offer programs that permit you to wear a hearing aid for a period of time for a nominal fee after which you may decide if you want to purchase the hearing aid.

Federal law restricts the sale of hearing aids to those individuals who have obtained a medical evaluation from a licensed physician. Federal law permits a fully informed adult to sign a waiver statement declining the medical evaluation for religious or personal beliefs that preclude consultation with a physician. The exercise of such a waiver is not in your best health interest and its use is strongly discouraged.

CE₀₄₈₂ **FDA MED/CERT**
